

Installation

You must install this window kit in conjunction with the accessories supplied with the AVAC9000CM Portable Air Conditioner.

- 1 You should follow the instructions for **Exhaust Duct Set Assembly and Installation** in the Installation and Use instruction leaflet supplied with the AVAC9000CM air conditioner. But **DO NOT** attach the Exhaust Nozzle.
- 2 Adjust the plastic window panel to the width or height of your window and secure by tightening the two screws.
- 3 Push the circular window panel adaptor through the rear (outside) of the window panel. Line up the holes and tighten the adaptor using the four screws.
- 4 Now install the window adaptor into the window.
- 5 Connect the exhaust hose between the air conditioner and the window panel adaptor by aligning the tabs and turning clockwise until it locks in place.
- 6 When the Air Conditioner is not in use, the cover should be used to cover the hole.

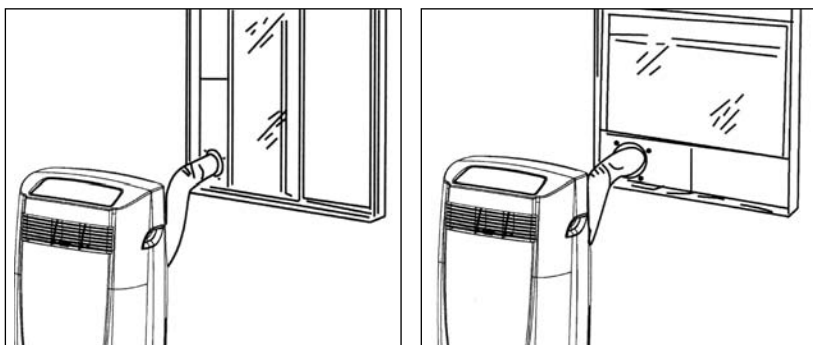

Waste electrical products should not be disposed of with household waste. Please recycle where facilities exist. Check with your local authority or retailer for recycling advice.

ADDVENT

Telephone: **0117 923 5375** Fax: **0117 923 5374**
 1, Avon Riverside, Victoria Road, Avonmouth, Bristol BS11 9DB
www.addvent.co.uk

ISSUE 1/0107

AVACWK Window Kit for use with AVAC9000CM Installation Instructions and User Guide

You must install this window kit in conjunction with the accessories supplied with the AVAC9000CM Portable air conditioner.

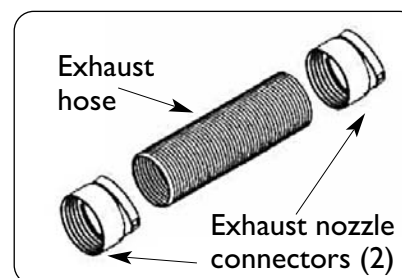

For use with a window of ??mm maximum with or height.

IMPORTANT SAFEGUARDS

WHEN USING ANY ELECTRICAL APPLIANCE, BASIC SAFETY PRECAUTIONS SHOULD ALWAYS BE FOLLOWED.

PLEASE READ ALL INSTRUCTIONS CAREFULLY AND RETAIN FOR FUTURE REFERENCE

ADDVENT